

Головки для экскаваторов

По вопросам продаж и поддержки обращайтесь:

Алматы (7273)495-231
Ангарск (3955)60-70-56
Архангельск (8182)63-90-72
Астрахань (8512)99-46-04
Барнаул (3852)73-04-60
Белгород (4722)40-23-64
Благовещенск (4162)22-76-07
Брянск (4832)59-03-52
Владивосток (423)249-28-31
Владикавказ (8672)28-90-48
Владимир (4922)49-43-18
Волгоград (844)278-03-48
Вологда (8172)26-4159
Воронеж (473)204-51-73
Екатеринбург (343)384-55-89
Иваново (4932)77-34-06
Ижевск (3412)26-03-58
Иркутск (395)279-98-46
Казань (843)206-01-48

Калининград (4012)72-03-81
Калуга (4842)92-23-67
Кемерово (3842)65-04-62
Киров (8332)68-02-04
Коломна (4966)23-41-49
Кострома (4942)77-07-48
Краснодар (861)203-40-90
Красноярск (391)204-63-61
Курск (4712)77-13-04
Курган (3522)50-90-47
Липецк (4742)52-20-81
Магнитогорск (3519)55-03-13
Москва (495)268-04-70
Мурманск (8152)59-64-93
Набережные Челны (8552)20-53-41
Нижний Новгород (831)429-08-12
Новокузнецк (3843)20-46-81
Ноябрьск (3496)41-32-12
Новосибирск (383)227-86-73

Омск (3812)21-46-40
Орел (4862)44-53-42
Оренбург (3532)37-68-04
Пенза (8412)22-31-16
Петрозаводск (8142)55-98-37
Псков (8112)59-10-37
Пермь (342)205-81-47
Ростов-на-Дону (863)308-18-15
Рязань (4912)46-61-64
Самара (846)206-03-16
Саранск (8342)22-96-24
Санкт-Петербург (812)309-46-40
Саратов (845)249-38-78
Севастополь (8692)22-31-93
Симферополь (3652)67-13-56
Смоленск (4812)29-41-54
Сочи (862)225-72-31
Ставрополь (8652)20-65-13
Сургут (3462)77-98-35

Сыктывкар (8212)25-95-17
Тамбов (4752)50-40-97
Тверь (4822)63-31-35
Тольятти (8482)63-91-07
Томск (3822)98-41-53
Тула (4872)33-79-87
Тюмень (3452)66-21-18
Ульяновск (8422)24-23-59
Улан-Удэ (3012)59-97-51
Уфа (347)229-48-12
Хабаровск (4212)92-98-04
Чебоксары (8352)28-53-07
Челябинск (351)202-03-61
Череповец (8202)49-02-64
Чита (3022)38-34-83
Якутск (4112)23-90-97
Ярославль (4852)69-52-93

Россия +7(495)268-04-70

Казахстан +7(7172)727-132

Киргизия +996(312)96-26-47

Адрес: <https://orsi.nt-rt.ru> || эл.почта: ois@nt-rt.ru



44° 41' 13" N
11° 20' 17" E

FOR TRADITION
ONE STEP AHEAD

EXCAVATORS

HEADQUARTER

MASCARINO DI CASTELLO D'ARGILE (BO) ITALY



OUR DISTRIBUTION WORLD WIDE

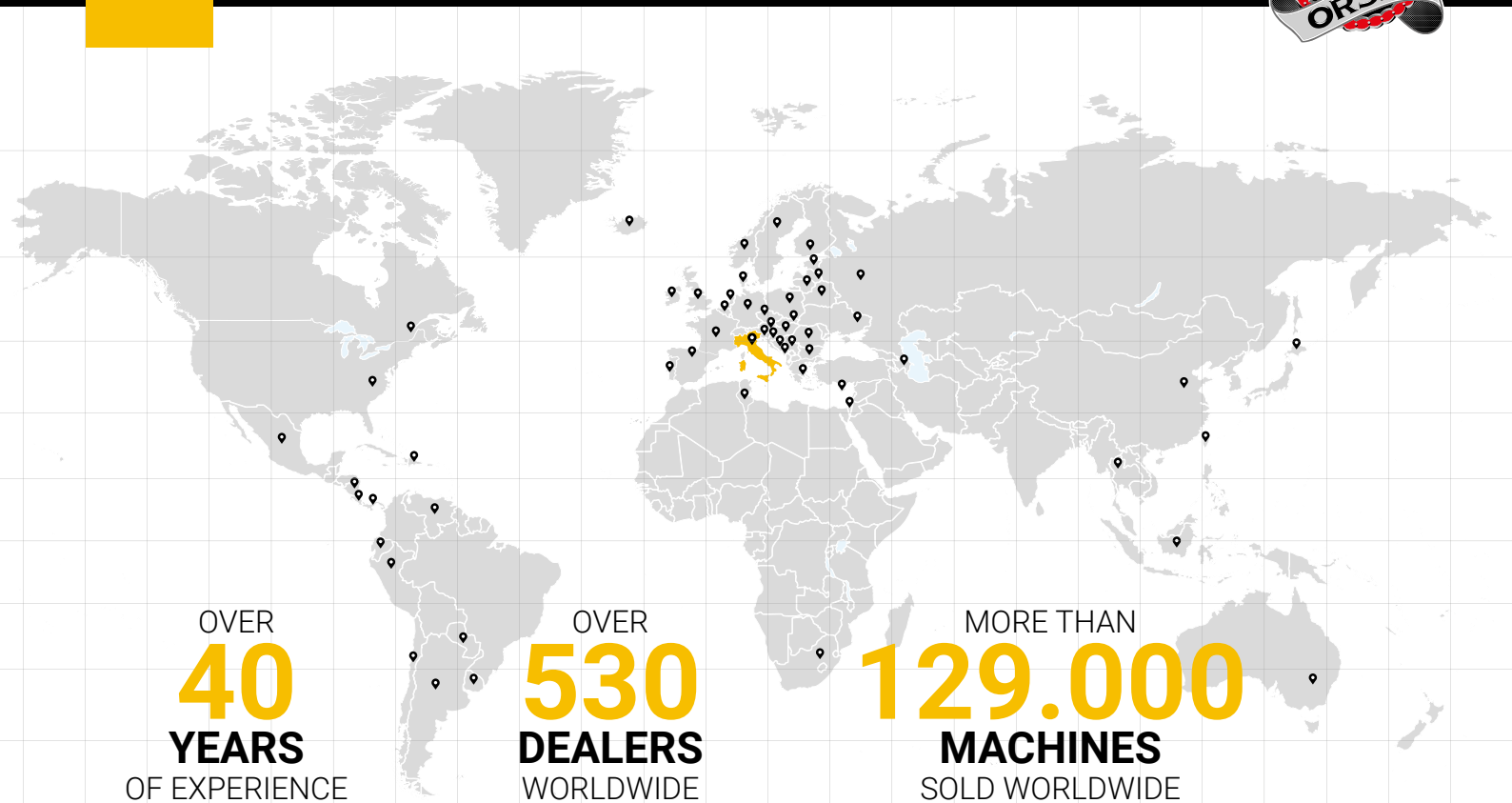

CERTIFICATIONS



CERTIFICATO



ORSI GROUP S.p.A. è certificata secondo lo standard
ISO 9001:2015

ORSI GROUP S.p.A.

ORSI GROUP S.p.A. è certificata secondo lo standard
ISO 9001:2015

ORSI GROUP S.p.A.
Sede Legale
Via S. Maria, 11
37060, Veroneta (Verona)

ORSI GROUP S.p.A.
Sede Legale
Via S. Maria, 11
37060, Veroneta (Verona)



ANTICORROSIVE TREATMENT

ANTICORROSIVE POWDER TREATMENT

- Shot Blasting SA Ø 2,5
- Primer application in zinc phosphate epoxy powder thickness 60-80 µm
- EXTRA polyurethane finishing powder (UV-resistant) thickness 60-80 µm polymerization at 180° for 20'
- Final dry thickness 120-160
- Orange colour RAL 2011
- Corrosivity class c5-i following DIN55633 and DIN EN ISO 12944-6 norms
- Salt spray resistance 2000h

RAW SHEET

GRITTED SHEET

SHEET COVERED WITH POLYURETHANE ENAMEL

SURFACE COVERED WITH ORANGE RAL 2011

ANTICORROSIVE LIQUID TREATMENT FOR MECHANICAL AND HYDRAULIC COMPONENTS

HIGH STRENGTH CYCLE

- Shot Blasting sa Ø 2,5
- Epoxy bi-component primer application in zinc CT90
- Expoprimer application CT113 grey 7035
- EXTRA bi-component polyurethane enamel application (UV-resistant)
- Final dry thickness 350-400 µm

STANDARD CYCLE

- Shot Blasting sa Ø 2,5
- Expoprimer application CT113 grey 7035
- EXTRA bi-component polyurethane enamel application (UV-resistant)
- Final dry thickness 180-200 µm

**“WHY AN EXCELLENT PAINTING IS IMPORTANT”
BECAUSE IT KEEPS THE PRICE
OF THE MACHINE ON THE
SECOND-HAND MARKET.**







WHY WE USE HARDOX?

Hardox® 450

The most popular abrasion-resistant steel with excellent structural properties.

Hardox® 450 is an abrasion-resistant steel with a nominal hardness of 450 HBW. Hardox® 450 combines good bendability and weldability with an option for guaranteed impact toughness (Hardox® 450 Tuf).

The products can be used in many different components and structures that are subject to wear. Hardox® 450, with an extra 50 Brinell hardness over our 400 grade, provides better dent and abrasion resistance as well as longer wear life, so you can achieve even greater savings.



WHY WE USE STRENX?

Superior properties

Strenx® steel has extremely consistent properties, ensuring precision and efficiency in the workshop.

If you think all steel is basically the same, Strenx® performance steel will change your thinking. Strong and reliable from surface to core, Strenx® steel features exceptional surface quality as well as impressive thickness and flatness tolerances verified by the Strenx® guarantees. The steel's properties - yield and tensile strength, bending performance, impact toughness - are carefully tested to ensure reliability and consistency in every delivery.

TECHNICAL INFORMATION



ORSI V3.1

Compact valve group proportioned to the oil flows necessary to the machineries. Just projected by ORSI's technical dept. to satisfy the needs of machineries attached to excavators. Anticavitation valve, max valve and flow divider; exhaust drainage collector and only 2 hoses for connection to the excavator (ingoing oil and direct return to the tank).



HYDRAULIC GEAR MOTOR

Hydraulic gear motor in cast iron. Designed to have excellent mechanical characteristics with a rigid and compact structure that guarantees excellent reliability and high volumetric performance even at high working pressures. Max 250 BAR.



REXROTH HYDRAULIC PISTON ENGINE

Constant displacement hydraulic motors with rotating assembly with axial conical pistons and inclined cylinder block. Very high quality, very high performance. Variable displacement hydraulic motors with rotating assembly with axial conical pistons and inclined cylinder block. By adjusting the inclined cylinder block, it is possible to modify the torque and the displacement continuously.



ASPORTABLE OSCILLATING PLATE

Autolevelling system specially bolted to the chassis with the same saddle attack drill. Possibility to remove it quickly for a greater accuracy and better operation in the profiling of the hedges. Also equipped with a locking pin in case of occasional use in the vertical profiles.

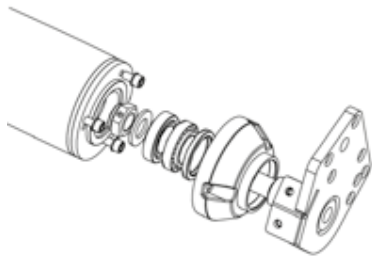
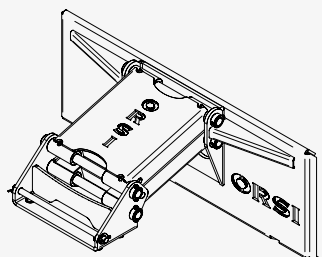

OSCILLATING HITCH WITH HYDRAULIC SIDE SHIFTA

Universal hitch plate for miniskids with integrated floating system, for a better adherence of the shredder to the working plane. Fixed to the shredder by means of a bolted stirrup for maximum flexibility over time.

PROFESSIONAL ROLLER

Professional support roller \varnothing 140 mm with 4 opposed tapered roller bearings. Interchangeable central body.

MOUNTING BRACKETS

Attachment bracket for excavator supplied on request (without pins).

ADAPTERS

ROTOR

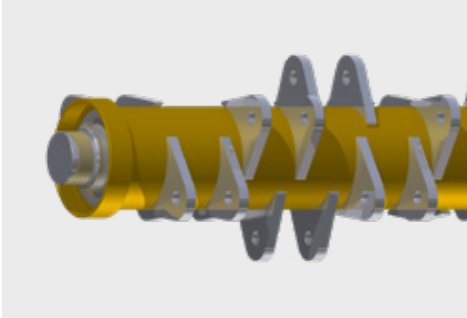

HELICOCUT

Rotor with helical cutting system design with 6 rows of tools, designed to reduce the efforts and give more homogeneity to the cut and therefore better performance. Possibility to change 4 or 5 types of tools on the same rotor to always have the more suited tool for the type of work to deal with. More efficiently with less effort.

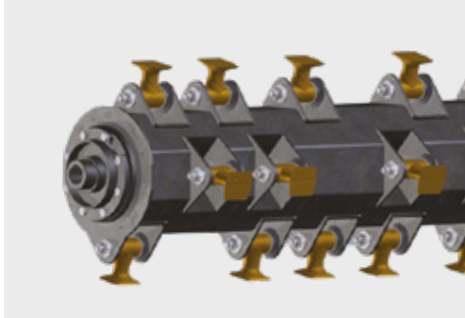

SEMIFOREST WITH ROTARY HAMMERS

Rotor with retractable rotating hammers specially designed to make more efficient the normal flail heads in the hard work of deforestation. Designed by ORSI to allow small excavators, spiders and all those machines able to climb the huge slopes of the high mountains, to clean small spaces. Mountable as standard or as a spare part at a later time, it becomes the ideal friend when the going gets tough and the spaces are narrow and cramped.



FOREST ROTOR WITH ROTATING HAMMERS

Professional forest rotor for deforestation. Suitable for aggressive work of plants abatement up to 12 cm in diameter. It is also ideal for cleaning the floor. Using the tool in both working directions will be created a clean surface and free from dangerous protrusion.

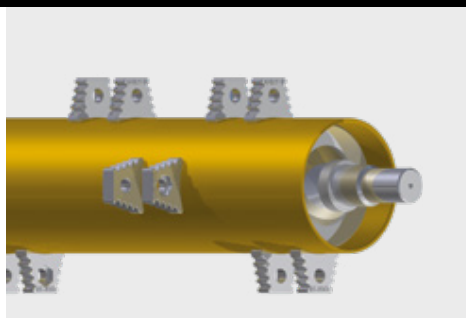

FOREST ROTOR WITH FIXED TEETH

Professional FOREST rotor for big deforestation. Born with helicoidal system and two spirals, it uses interchangeable tools in tungsten. Maximum aggression and excellent performance make this rotor the most powerful tool for heavier works.

“VENTILATOR” ROTOR

Electronically balanced. Forest type tool holders moulded in boron steel

ROTOR WITH “FLANGES TOOL LIMITER” (FTL) TECHNOLOGY

Excellent performance and speed with less power requested.

The working depth of the tools is limited by steel flanges, reducing the requested power and still guaranteeing high performances.



1,2 ÷ 2,5 ton.





max Ø 2,5 cm

A mulcher for mini excavators, equipped with a hammers or knives rotor.

The smallest mulcher in our construction range, designed for cleaning bushes and shrubs.

The mulcher can be equipped with either a standard 8 cc motor or with an 11 cc or 16 cc one, and it is intended to be used on 1.2 to 2.5 t excavators.

	RPM		
8 c.c.	2.500 - 3.000	20-25 lt/min	220 max BAR
11 c.c.	2.500 - 3.000	28-33 lt/min	220 max BAR
16 c.c.	2.500 - 3.000	40-48 lt/min	220 max BAR

BASIC 80

HYDRAULIC CUTTING HEAD





STRENGTH POINTS



BASIC 80

PROFESSIONAL SERIES

BASIC 80		A	B
TECHNICAL SPECIFICATIONS			
Working width		80 cm	80 cm
Overall width		95 cm	95 cm
Machine weight*		75+100 kg	75+100 kg
Direct transmission		✓	✓
		<i>*variable weight based on the layout</i>	
tools	 Knives A max Ø 1,5cm	N° 40	-
	 Hammers B max Ø 2,5 cm	-	N° 20

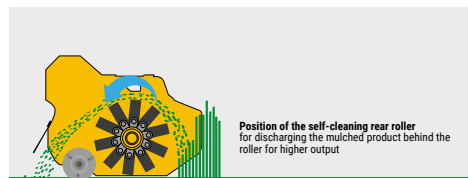

BASIC 80	A	B
MACHINE		
Rear roller Ø 100 cm adjustable in height	✓	✓
Replaceable skids	✓	✓
Removable oscillating plate	✓	✓
Standard mounting brackets (no pins)	•	•
Adapters	•	•
TRANSMISSION		
VARISEAL engine with external drainage	✓	✓
Rotor with possibility of use 2 types of tools	✓	✓
Double-row self-aligning ball bearings	✓	✓
Unidirectional rotor rotation	✓	✓
HYDRAULIC SYSTEM		
One way valve on return	✓	✓
ORSI V3.1-1/2: valve of max. pressure + anticavitation valve + flux regulator 3 connecting hoses to the machine. Max backpressure on oil drainage = 12 BAR	✓	✓





2,5 ÷ 7 ton.



max Ø 5 cm

A mulcher that can be equipped with either a 16 cc motor or with a 22 cc or 27 cc one, and it is intended to be used on excavators from 2.5 to 7 t. This mulcher is designed for cleaning bushes and shrubs up to 5 cm in size, and it has a wide range of tools. The "BELT" version comes with a pulley transmission instead of a direct motor.

	RPM		
16 c.c.	2.500 - 3.000	40=48 lt/min	220 max BAR
22 c.c.	2.500 - 3.000	55=65 lt/min	220 max BAR
27 c.c.	2.500 - 3.000	68=81 lt/min	220 max BAR

INDUSTRIAL

HYDRAULIC CUTTING HEAD







STRENGTH POINTS



INDUSTRIAL

PROFESSIONAL SERIES

INDUSTRIAL	80	105	125	105 BELT	125 BELT	
TECHNICAL SPECIFICATIONS						
Working width	80 cm	105 cm	125 cm	105 cm	125 cm	
Overall width total	105 cm	130 cm	150 cm	125 cm	145 cm	
Machine weight*	250-300 kg	270-320 kg	300-350 kg	270-320 kg	300-350 kg	
Direct transmission	✓	✓	✓	-	-	
Belts transmission	-	-	-	2 cinghie	2 cinghie	
tools	 D max Ø 3 cm	N° 32	N° 40	N° 48	N° 40	N° 48
	 O max Ø 3 cm	N° 32	N° 40	N° 48	N° 40	N° 48
	 E max Ø 4 cm	N° 16	N° 20	N° 24	N° 20	N° 24
	 F max Ø 4 cm	N° 16	N° 20	N° 24	N° 20	N° 24
	 N max Ø 5 cm	N° 16	N° 20	N° 24	N° 20	N° 24

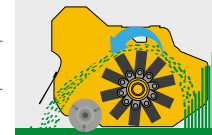

Position of the self-cleaning rear roller for discharging the mulched product behind the roller for higher output



MULTI-KNIFE ROTOR
A: Ø 102 x 12,5 mm



INDUSTRIAL	80	105	125	105 BELT	125 BELT
MACHINE					
Rear roller Ø 140 mm with 4 tapered roller bearings and interchangeable central body thickness 6 mm, adjustable in height	✓	✓	✓	✓	✓
Replaceable skids	✓	✓	✓	✓	✓
Blade cutting system	✓	✓	✓	✓	✓
Front and rear protection rubber	✓	✓	✓	✓	✓
Removable oscillating plate	✓	✓	✓	✓	✓
Mechanical rotation 180° (A.)	•	•	•	•	•
Hydraulic rotation 180° (n°2 hydraulic hoses) (B.)	•	•	•	•	•
Standard mounting brackets (no pins)	•	•	•	•	•
Adapters	•	•	•	•	•
Selflevelling "universal" skid coupler	•	•	•	•	•
Coupler for loaders/ telescopic lifters/ backhoes	•	•	•	•	•
TRANSMISSION					
VARISEAL engine with external drainage	✓	✓	✓	✓	✓
"Helicocut" rotor	✓	✓	✓	✓	✓
Double-row self-aligning ball bearings	✓	✓	✓	✓	✓
Unidirectional rotor rotation	✓	✓	✓	✓	✓
HYDRAULIC SYSTEM					
One way valve on return	✓	✓	✓	✓	✓
ORSI V3,1-1/2: valve of max. pressure + anticavitation valve + flux regulator. 3 connecting hoses to the machine. Max backpressure on oil drainage = 12 BAR with engine 16-22 cc.	✓	✓	✓	✓	✓
ORSI V3,1-3/4: valve of max. pressure + anticavitation valve + flux regulator. 3 connecting hoses to the machine. Max backpressure on oil drainage = 12 BAR with engine 27 cc.	✓	✓	✓	✓	✓



C./D.



A.

B.

enable weight based on the layout





5 ÷ 12 ton.



max Ø 8/10 cm

A HARDOX machine that can be equipped with a 22 cc, 27 cc or 38 cc motor, and it is intended to be used on excavators from 5 to 12 t. Designed for cleaning bushes, shrubs and wood up to 10 cm in size, with a wide range of tools and also the possibility to equip a semi-forestry rotor.

	RPM		
22 c.c.	2.500 - 3.000	55-65 lt/min	250 max BAR
27 c.c.	2.500 - 3.000	68-81 lt/min	250 max BAR
38 c.c.	2.500 - 3.000	95-115 lt/min	250 max BAR





PROFESSIONAL

HYDRAULIC CUTTING HEAD

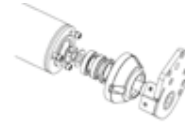

STRENGTH POINTS



PROFESSIONAL	105	125	150	105	125	125	125	180
								

TECHNICAL SPECIFICATIONS								
Working width	105 cm	125 cm	150 cm	105 cm	125 cm	125 cm	125 cm	180 cm
Overall width total	135 cm	155 cm	180 cm	135 cm	155 cm	155 cm	155 cm	210 cm
Machine weight*	380-430 kg	420-490 kg	480-530 kg	380-430 kg	420-490 kg	420-490 kg	420-490 kg	540-590 kg
Direct transmission	✓	✓	✓	✓	✓	✓	✓	✓
tools	C max Ø 3 cm	N° 32	N° 48	N° 72	-	-	-	-
	G max Ø 4 cm	N° 16	N° 24	N° 36	-	-	-	-
	B max Ø 4 cm	N° 16	N° 24	N° 36	-	-	-	-
	M max Ø 6 cm	N° 16	N° 24	N° 36	-	-	-	-
	P max Ø 5 cm	-	-	-	N° 32	N° 40	-	-
	Q max Ø 5 cm	-	-	-	N° 32+16	N° 40+20	-	-
	V max Ø 8 cm	-	-	-	-	-	N° 24	-
	T max Ø 8/10 cm	-	-	-	-	-	-	N° 20

PROFESSIONAL	105	125	150	180
MACHINE				
Steel frame with internal counter-frame (double frame)	✓	✓	✓	✓
Static knife in Hardox and blade cutting system	✓	✓	✓	✓
Rear roller Ø 140 mm with 4 tapered roller bearings and interchangeable central body thickness 6 mm, adjustable in height	✓	✓	✓	✓
Replaceable skids	✓	✓	✓	✓
Front and rear protection rubber	✓	✓	✓	✓
Removable oscillating plate	✓	✓	✓	✓
Mechanical rotation 180° (A.)	•	•	•	•
Hydraulic rotation 180° (n°2 hydraulic hoses) (B.)	•	•	•	•
Standard mounting brackets (no pins)	•	•	•	•
Adapters	•	•	•	•
Selflevelling "universal" skid coupler	•	•	•	•
CCoupler for loaders/ telescopic lifters/ backhoes	•	•	•	•
Hydraulic openable bonnet with machine already set up	•	•	•	•
TRANSMISSION				
VARISEAL engine with external drainage	✓	✓	✓	✓
"Helicocut" rotor	✓	✓	✓	✓
Double-row self-aligning ball bearings	✓	✓	✓	✓
Unidirectional rotor rotation	✓	✓	✓	✓
HYDRAULIC SYSTEM				
One way valve on return	✓	✓	✓	✓
ORSI V3.1-3/4: valve of max. pressure + anticavitation valve + flux regulator. 3 connecting hoses to the machine. Max backpressure on oil drainage = 12 BAR	✓	✓	✓	✓

PROFESSIONAL

PROFESSIONAL SERIES

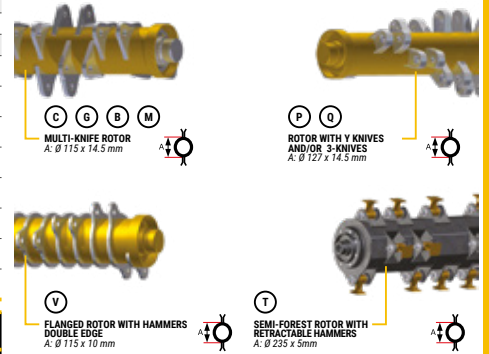

*variable weight based on the layout.



8 ÷ 15 ton.





max Ø 8/10 cm

A HARDOX machine that can be equipped with either a 22 cc or with a 27 cc or 38 cc motor, and it is intended to be used on excavators from 5 to 12 t.

Designed for cleaning bushes, shrubs and wood up to 10 cm in size, with a wide range of tools and also the possibility to equip a semi-forestry rotor.

This version comes with a pulley transmission for a greater strength of the rotor during the work.

	RPM		
22 c.c.	2.500 - 3.000	55-65 lt/min	250 max BAR
27 c.c.	2.500 - 3.000	68-81 lt/min	250 max BAR
38 c.c.	2.500 - 3.000	95-115 lt/min	250 max BAR





PROFESSIONAL *BELT*

HYDRAULIC CUTTING HEAD

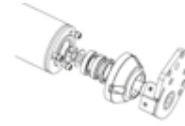

STRENGTH POINTS



PROFESSIONAL BELT	105	125	150	105	125	125	125	180
								

TECHNICAL SPECIFICATIONS								
Working width	105 cm	125 cm	150 cm	105 cm	125 cm	125 cm	125 cm	180 cm
Overall width total	135 cm	145 cm	170 cm	135 cm	145 cm	135 cm	145 cm	200 cm
Machine weight*	390-440 kg	430-500 kg	490-540 kg	390-440 kg	430-500 kg	490-540 kg	430-500 kg	550-600 kg
Belts transmission	3 belts	3 belts	3 belts	3 belts	3 belts	3 belts	3 belts	3 belts
tools	C max Ø 3 cm	N° 32	N° 48	N° 72	-	-	-	-
	G max Ø 4 cm	N° 16	N° 24	N° 36	-	-	-	-
	B max Ø 4 cm	N° 16	N° 24	N° 36	-	-	-	-
	M max Ø 6 cm	N° 16	N° 24	N° 36	-	-	-	-
	P max Ø 5 cm	-	-	-	N° 32	N° 40	-	-
	Q max Ø 5 cm	-	-	-	N° 32+16	N° 40+20	-	-
	V max Ø 8 cm	-	-	-	-	-	N° 24	-
T max Ø 7/10 cm	-	-	-	-	-	-	N° 20	N° 32

PROFESSIONAL BELT	105	125	150	180
MACHINE				
Steel frame with internal counter-frame (double frame)	✓	✓	✓	✓
Static knife in Hardox and blade cutting system	✓	✓	✓	✓
Rear roller Ø 140 mm with 4 tapered roller bearings and interchangeable central body thickness 6 mm, adjustable in height	✓	✓	✓	✓
Replaceable skids	✓	✓	✓	✓
Front and rear protection rubber	✓	✓	✓	✓
Removable oscillating plate	✓	✓	✓	✓
Mechanical rotation 180° (A.)	•	•	•	•
Hydraulic rotation 180° (n°2 hydraulic hoses) (B.)	•	•	•	•
Standard mounting brackets (no pins)	•	•	•	•
Adapters	•	•	•	•
Selflevelling "universal" skid coupler	•	•	•	•
CCoupler for loaders/ telescopic lifters/ backhoes	•	•	•	•
Hydraulic openable bonnet with machine already set up	•	•	•	•
TRANSMISSION				
VARISEAL engine with external drainage	✓	✓	✓	✓
"Helicocut" rotor	✓	✓	✓	✓
Trasmissione a cinghie	✓	✓	✓	✓
Double-row self-aligning ball bearings	✓	✓	✓	✓
Unidirectional rotor rotation	✓	✓	✓	✓
HYDRAULIC SYSTEM				
One way valve on return	✓	✓	✓	✓
ORSI V3, 1-3/4: valve of max. pressure + anticavitation valve + flux regulator. 3 connecting hoses to the machine. Max backpressure on oil drainage = 12 BAR	✓	✓	✓	✓

PROFESSIONAL BELT

PROFESSIONAL SERIES

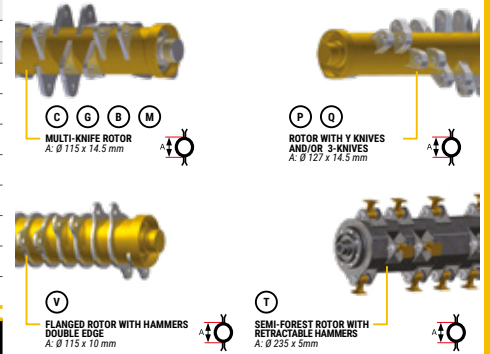





8 ÷ 15 ton.



max Ø 10 cm

A HARDOX machine equipped with either a 35 cc or a 44 cc axial piston motor, and it is intended to be used on excavators from 8 to 15 t. Designed for cleaning bushes, shrubs and wood up to 10 cm in size, with a wide range of tools and also the possibility to equip a semi-forestry rotor.

	RPM		
35 c.c.	2.500 - 3.000	85=100 lt/min	350 max BAR
44 c.c.	2.500 - 3.000	110=120 lt/min	350 max BAR





PROFESSIONAL PISTON

HYDRAULIC CUTTING HEAD

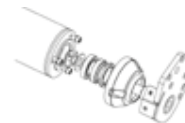

STRENGTH POINTS



PROFESSIONAL PISTON	105	125	150	105	125	125	125	180
								

TECHNICAL SPECIFICATIONS								
Working width	105 cm	125 cm	150 cm	105 cm	125 cm	125 cm	125 cm	180 cm
Overall width total	125 cm	145 cm	170 cm	125 cm	145 cm	145 cm	145 cm	200 cm
Machine weight*	390-440 kg	430-500 kg	490-540 kg	390-440 kg	430-500 kg	430-500 kg	430-500 kg	550-600 kg
Belts transmission	1 belt	1 belt	1 belt	1 belt	1 belt	1 belt	1 belt	1 belt
tools	C max Ø 3 cm	N° 32	N° 48	N° 72	-	-	-	-
	G max Ø 4 cm	N° 16	N° 24	N° 36	-	-	-	-
	B max Ø 4 cm	N° 16	N° 24	N° 36	-	-	-	-
	M max Ø 6 cm	N° 16	N° 24	N° 36	-	-	-	-
	P max Ø 5 cm	-	-	-	N° 32	N° 40	-	-
	Q max Ø 5 cm	-	-	-	N° 32+16	N° 40+20	-	-
	V max Ø 8 cm	-	-	-	-	-	N° 24	-
T max Ø 10 cm	-	-	-	-	-	-	N° 20	

PROFESSIONAL PISTON	105	125	150	180
MACHINE				
Steel frame with internal counter-frame (double frame)	✓	✓	✓	✓
Static knife in Hardox and blade cutting system	✓	✓	✓	✓
Rear roller Ø 140 mm with 4 tapered roller bearings and interchangeable central body thickness 6 mm, adjustable in height	✓	✓	✓	✓
Replaceable skids	✓	✓	✓	✓
Front and rear protection rubber	✓	✓	✓	✓
Removable oscillating plate	✓	✓	✓	✓
Mechanical rotation 180° (A.)	•	•	•	•
Hydraulic rotation 180° (n°2 hydraulic hoses) (B.)	•	•	•	•
Standard mounting brackets (no pins)	•	•	•	•
Adapters	•	•	•	•
Selflevelling "universal" skid coupler	•	•	•	•
Coupler for loaders/ telescopic lifters/ backhoes	•	•	•	•
Hydraulic openable bonnet with machine already set up	•	•	•	•
TRANSMISSION				
Unidirectional engine at axial pistons with external drainage	✓	✓	✓	✓
"Helicocut" rotor	✓	✓	✓	✓
Transmission with toothed belt in kevlar on toothed pulleys	✓	✓	✓	✓
Double-row self-aligning ball bearings	✓	✓	✓	✓
Unidirectional rotor rotation	✓	✓	✓	✓
HYDRAULIC SYSTEM				
One way valve on return	✓	✓	✓	✓
ORSI V3 1-3/4 which includes valve of max. pressure + anticavitation valve + flow regulator. 3 connecting hoses to the machine. Max backpressure on oil drainage = 2 BAR	✓	✓	✓	✓

PROFESSIONAL PISTON

PROFESSIONAL SERIES

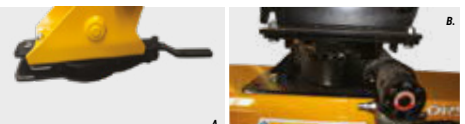
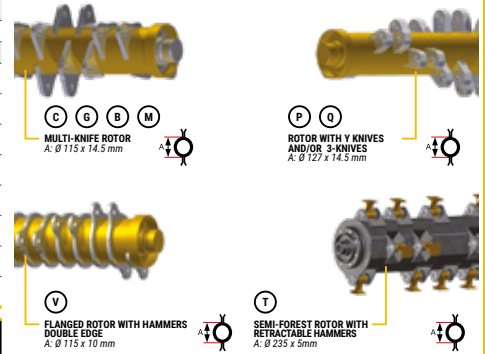

variable weight based on the layout



10 ÷ 20 ton.



max Ø 10 cm

A HARDOX machine with axial piston motor that can be equipped with either a 35 cc or 44 cc motor, and it is intended to be used on excavators from 10 to 20 t.

Designed for cleaning bushes, shrubs and wood up to 10 cm in size, with a wide range of tools and also the possibility to equip a semi-forestry rotor.



TP HARDOX PISTON



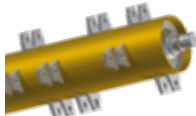

HYDRAULIC CUTTING HEAD



STRENGTH POINTS



		RPM		
	PISTON			
L	35 c.c.	2.150 - 2.600	85-95 lt/min	350 max BAR
	44 c.c.	2.150 - 2.700	105-115 lt/min	350 max BAR
CGBM PQ V	35 c.c.	2.600 - 3.000	91-105 lt/min	350 max BAR
	44 c.c.	2.600 - 3.000	105-115 lt/min	350 max BAR

NEW TP HARDOX PISTON	125	125	125	125	125 FORREST
					

TECHNICAL SPECIFICATIONS					
Working width	125 cm	125 cm	125 cm	125 cm	125 cm
Overall width total	155 cm	155 cm	155 cm	155 cm	155 cm
Machine weight*	470-540 kg	430-480 kg	470-540 kg	490-550 kg	470-540 kg
Belts transmission	1 toothed belt	1 toothed belt	1 toothed belt	1 toothed belt	1 toothed belt
tools	C max Ø 3 cm	N° 48	-	-	-
	G max Ø 4 cm	N° 24	-	-	-
	B max Ø 4 cm	N° 24	-	-	-
	M max Ø 6 cm	N° 24	-	-	-
	P max Ø 5 cm	-	N° 40	-	-
	Q max Ø 5 cm	-	N° 40+20	-	-
	Y max Ø 8 cm	-	-	N° 24	-
	L max Ø 8/10 cm	-	-	-	N° 12
T max Ø 8/10 cm	-	-	-	-	N° 20

NEW TP HARDOX PISTON	125	125 FORREST
MACHINE		
Reinforced monoocque frame th. 5 mm in Hardox	✓	✓
Reinforced sides th. 6 mm	✓	✓
2 bars of counter - knife for fine shredding	✓	✓
Replaceable skids with adjustable and replaceable pads	✓	✓
Professional rear roller Ø 195 mm with 4 taper roller bearings and central body interchangeable	✓	✓
Removable oscillating plate	✓	✓
Mechanical rotation 180° (A.)	•	•
Hydraulic rotation 180° (n°2 hydraulic hoses) (B.)	•	•
Standard mounting brackets (no pins)	•	•
Adapters	•	•
Selflevelling "universal" skid coupler	•	•
Coupler for loaders/ telescopic lifters/ backhoes	•	•
Hydraulic openable bonnet with machine already set up	•	•
TRANSMISSION		
Unidirectional engine at axial pistons with external drainage	✓	✓
Double-row self-aligning ball bearings	✓	✓
"Helicocut" rotor	✓	-
Semi-forest rotor with rotating hammers with tool "T"	-	✓
HYDRAULIC SYSTEM		
One way valve on return	✓	✓
ORSI V3.1-3/4 which includes valve of max. pressure + anticavitation valve + flow regulator. 3 connecting hoses to the machine. Max backpressure on oil drainage = 2 BAR	✓	✓

TP HARDOX PISTON

PROFESSIONAL SERIES

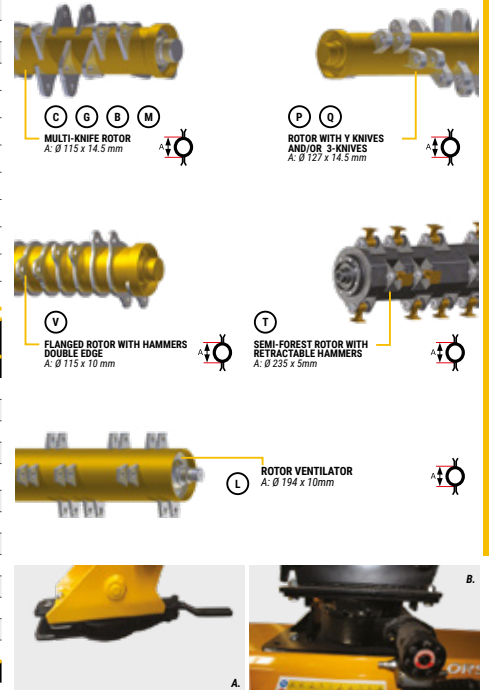



10 ÷ 20 ton.





max Ø 5 cm

A HARDOX machine with pulley transmission that can be equipped with either 27 cc, 38 cc, 51 cc or 61 cc motor, which is intended to be used on excavators from 10 to 20 t. Designed for cleaning bushes, shrubs and wood up to 6 cm in size, equipped with a hammers or knives rotor.

HARDOX
IN MY BODY



	RPM		
27 c.c.	2.300 - 2.500	43-50 lt/min	250 max BAR
38 c.c.	2.300 - 2.500	60-70 lt/min	250 max BAR
51 c.c.	2.300 - 2.500	80-90 lt/min	250 max BAR
61 c.c.	2.100 - 2.350	90-100 lt/min	250 max BAR

WT BELTS

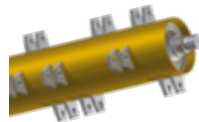

HYDRAULIC CUTTING HEAD

STRENGTH POINTS



WT BELTS

PROFESSIONAL SERIES

WT BELTS		135	165	180	200	220
TECHNICAL SPECIFICATIONS						
Working width		135 cm	162 cm	181 cm	201 cm	221 cm
Overall width		155 cm	180 cm	200 cm	220 cm	240 cm
Machine weight*		560-660 kg	600-700 kg	640-740 kg	680-780 kg	750-850 kg
Belts transmission		4 belts	4 belts	4 belts	4 belts	4 belts
tools	 Knives A max Ø 3 cm	N° 36	N° 36	N° 48	N° 48	N° 48
	 Hammers B max Ø 5/6 cm	N° 12	N° 12	N° 16	N° 16	N° 16

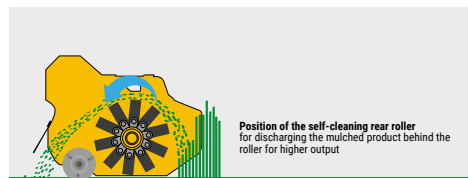

WT BELTS	135	165	180	200	220
MACHINE					
Steel frame with internal Hardox frame (double frame)	✓	✓	✓	✓	✓
Static knife in Hardox and blade cutting system	✓	✓	✓	✓	✓
Rear roller Ø 140 mm with 4 tapered roller bearings and interchangeable central body thickness 6 mm, adjustable in height	✓	✓	✓	✓	✓
Front protection flaps	✓	✓	✓	✓	✓
Removable oscillating plate	✓	✓	✓	✓	✓
Protection chains	•	•	•	•	•
Replaceable skids	•	•	•	•	•
Hydraulic rotation 180° (n°2 hydraulic hoses)	•	•	•	•	•
Standard mounting brackets (no pins)	•	•	•	•	•
Adapters	•	•	•	•	•
TRANSMISSION					
VARISEAL engine with external drainage	✓	✓	✓	✓	✓
Ventilator rotor	✓	✓	✓	✓	✓
Transmission with toothed belt	✓	✓	✓	✓	✓
Double-row self-aligning roller bearings	✓	✓	✓	✓	✓
Automatic belt tensioner	✓	✓	✓	✓	✓
Unidirectional rotor rotation	✓	✓	✓	✓	✓
HYDRAULIC SYSTEM					
One way valve on return	✓	✓	✓	✓	✓
ORSI V3.1-3/4 which includes valve of max. pressure + anticavitation valve + flow regulator. 3 connecting hoses to the machine. Max backpressure on oil outgoing = 12 BAR	✓	✓	✓	✓	✓







10 ÷ 20 ton.



max Ø 5 cm

A HARDOX machine equipped with a 35 cc or a 44 cc axial piston motor, intended to be used on excavators from 10 to 20 t. Designed for cleaning bushes, shrubs and wood up to 6 cm in size.

	RPM		
35 c.c.	2.300 - 2.500	56-65 lt/min	350 max BAR
44 c.c.	2.300 - 2.500	70-80 lt/min	350 max BAR

WT PISTON

HYDRAULIC CUTTING HEAD



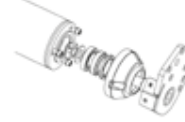
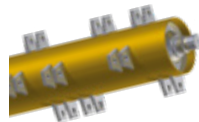

STRENGTH POINTS



WT PISTON

PROFESSIONAL SERIES

WT PISTON		135	165	180	200	220	NEW 255
TECHNICAL SPECIFICATIONS							
Working width		135 cm	162 cm	181 cm	201 cm	221 cm	253 cm
Overall width		155 cm	180 cm	200 cm	220 cm	240 cm	268 cm
Machine weight*		560-660 kg	600-700 kg	640-740 kg	680-780 kg	750-850 kg	790-890 kg
Belts transmission		4 belts	4 belts	4 belts	4 belts	4 belts	4 belts
utensili	 Knives A max Ø 3 cm	N° 36	N° 36	N° 48	N° 48	N° 48	N° 60
	 Hammers B max Ø 5/6 cm	N° 12	N° 12	N° 16	N° 16	N° 16	N° 20

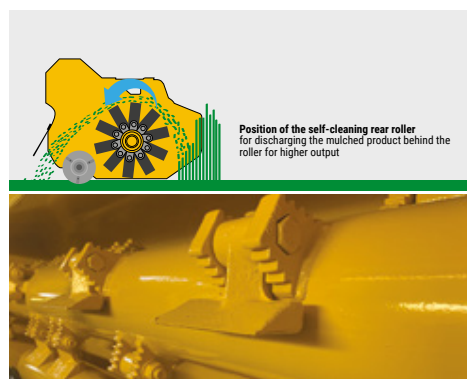

WT PISTON	135	165	180	200	220	NEW 255
MACHINE						
Steel frame with internal Hardox frame (double frame)	✓	✓	✓	✓	✓	✓
Static knife in Hardox and blade cutting system	✓	✓	✓	✓	✓	✓
Rear roller Ø 140 mm with 4 tapered roller bearings and interchangeable central body thickness 6 mm, adjustable in height	✓	✓	✓	✓	✓	✓
Front protection flaps	✓	✓	✓	✓	✓	✓
Removable oscillating plate	✓	✓	✓	✓	✓	✓
Protection chains	•	•	•	•	•	•
Replaceable skids	•	•	•	•	•	•
Hydraulic rotation 180° (n°2 hydraulic hoses)	•	•	•	•	•	•
Standard mounting brackets (no pins)	•	•	•	•	•	•
Adapters	•	•	•	•	•	•
TRANSMISSION						
Unidirectional engine at axial pistons with external drainage	✓	✓	✓	✓	✓	✓
Ventilator rotor	✓	✓	✓	✓	✓	✓
Belt transmission	✓	✓	✓	✓	✓	✓
Double-row self-aligning roller bearings	✓	✓	✓	✓	✓	✓
Automatic belt tensioner	✓	✓	✓	✓	✓	✓
Unidirectional rotor rotation	✓	✓	✓	✓	✓	✓
HYDRAULIC SYSTEM						
One way valve on return	✓	✓	✓	✓	✓	✓
ORSI V3.1-34 which includes valve of max. pressure + anticavitation valve + flow regulator. 3 connecting hoses to the machine. Max backpressure on oil drainage = 2 BAR	✓	✓	✓	✓	✓	✓





3,5 ÷ 7 ton.



max Ø 8 cm

New SEMI FORREST IND line, a mulcher for excavators, also available with our "Flanges Tool Limiter" technology, with special steel profiles that limit the tools' depth of action, reducing the power demand and ensuring working speed and exceptional performance. A machine designed for cleaning bushes, shrubs and wood up to 8 cm in size, with a wide range of tools.

Available with a motor of 16 cc, 22 cc or 27 cc, for medium-sized excavators from 3.5 to 7 t.

	RPM		
16 c.c.	2.500 - 3.000	40-48 lt/min	250 max BAR
22 c.c.	2.500 - 3.000	55-65 lt/min	250 max BAR
27 c.c.	2.500 - 3.000	68-81 lt/min	250 max BAR

SEMI FORREST *IND*

FOREST HYDRAULIC CUTTING HEAD



STRENGTH POINTS



SEMI FORREST <i>IND</i>	80	105	<i>NEW</i> 80 FTL	<i>NEW</i> 105 FTL
				

TECHNICAL SPECIFICATIONS				
Working width	80 cm	105 cm	80 cm	105 cm
Overall width total	133 cm	133 cm	133 cm	133 cm
Machine weight*	250÷300 kg	320÷380 kg	280÷330 kg	350÷410 kg
Direct transmission	✓	✓	✓	✓
tools	D max Ø 3 cm	N° 32	N° 40	-
	O max Ø 3 cm	N° 32	N° 40	-
	E max Ø 4 cm	N° 16	N° 20	-
	F max Ø 4 cm	N° 16	N° 20	-
	H max Ø 6 cm	N° 16	N° 20	-
	 max Ø 8 cm	-	-	N° 22

SEMI FORREST <i>IND</i>	80 / <i>NEW</i> 80 FTL	105 / <i>NEW</i> 105 FTL
MACHINE		
Steel frame with internal Hardox frame (double frame)	✓	✓
Static knife in Hardox and blade cutting system	✓	✓
Replaceable skids with adjustable and replaceable pads	✓	✓
Front and rear protection chains	✓	✓
Mechanical rotation 180° (A.)	•	•
Hydraulic rotation 180° (n°2 hydraulic hoses) (B.)	•	•
Standard mounting brackets (no pins)	•	•
Adapters	•	•
TRANSMISSION		
VARISEAL engine with external drainage	✓	✓
"Helicocut" rotor	✓	✓
Double-row self-aligning ball bearings	✓	✓
Unidirectional rotor rotation	✓	✓
HYDRAULIC SYSTEM		
One way valve on return	✓	✓
ORSI V3,1-1/2: valve of max. pressure + anticavitation valve + flux regulator. 3 connecting hoses to the machine. Max backpressure on oil drainage = 12 BAR with engine 16-22 cc	✓	✓
ORSI V3,1-3/4: engine 27 cc valve of max. pressure + anticavitation valve + flux regulator. 3 connecting hoses to the machine. Max backpressure on oil drainage = 12 BAR with engine 27 cc	✓	✓

SEMI FORREST *IND*

PROFESSIONAL SERIES

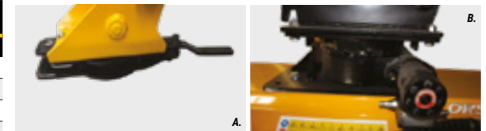
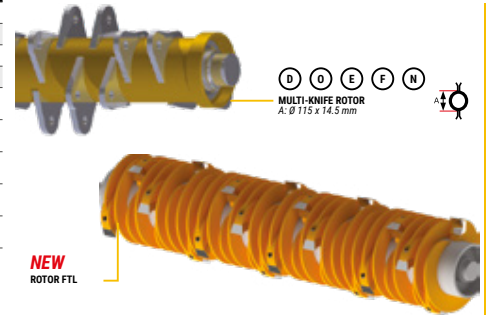



5 - 12 ton.





max Ø 8/10 cm

New SEMI FORREST PROF line, a mulcher for excavators, also available with "Flanges Tool Limiter" technology, with special steel profiles that limit the tools' depth of action, reducing the power demand and ensuring working speed and exceptional performance. A machine designed for cleaning bushes, shrubs and wood up to 8 cm in size, with a wide range of tools.

This machine comes with a pulley transmission, for higher performances.

Available with motors of 22 cc, 27 cc or 38 cc, ideal for excavators from 5 to 12 t.

	RPM		
22 c.c.	2.500 - 3.000	55-65 lt/min	250 max BAR
27 c.c.	2.500 - 3.000	68-81 lt/min	250 max BAR
38 c.c.	2.500 - 3.000	95-115 lt/min	250 max BAR

SEMI FORREST PROF

FOREST HYDRAULIC CUTTING HEAD



STRENGTH POINTS



SEMI FORREST PROF	125				NEW 125 FTL
	C G B M	P Q	V	T	

TECHNICAL SPECIFICATIONS					
Working width	125 cm	125 cm	125 cm	125 cm	125 cm
Overall width total	145 cm	145 cm	145 cm	145 cm	145 cm
Machine weight*	495÷515 kg	495÷515 kg	495÷515 kg	525÷545 kg	530÷550 kg
Belts transmission	3 belts	3 belts	3 belts	3 belts	3 belts
Tools	C max Ø 3 cm	N° 48	-	-	-
	G max Ø 4 cm	N° 24	-	-	-
	B max Ø 4 cm	N° 24	-	-	-
	M max Ø 6 cm	N° 24	-	-	-
	P max Ø 5 cm	-	N° 40	-	-
	Q max Ø 5 cm	-	N° 40+20	-	-
	V max Ø 8 cm	-	-	N° 24	-
	T max Ø 8/10 cm	-	-	-	N° 20
	max Ø 8/10 cm	-	-	-	N° 26

SEMI FORREST PROF	125 / NEW 125 FTL
MACHINE	
Steel frame with internal Hardox frame (double frame)	✓
Static knife in Hardox and blade cutting system	✓
Replaceable skids with adjustable and replaceable pads	✓
Front and rear protection chains	✓
Mechanical rotation 180°	•
Hydraulic rotation 180° (n°2 hydraulic hoses)	•
Standard mounting brackets (no pins)	•
Adapters	•
TRANSMISSION	
VARISEAL engine with external drainage	✓
Belt transmission	✓
"Helicocut" rotor	✓
Double-row self-aligning ball bearings	✓
Unidirectional rotor rotation	✓
HYDRAULIC SYSTEM	
One way valve on return	✓
ORSI V3, 1-3/4 which includes valve of max. pressure + anticavitation valve + flow regulator. 3 connecting hoses to the machine. Max backpressure on oil drainage = 12 BAR	✓

SEMI FORREST PROF

PROFESSIONAL SERIES

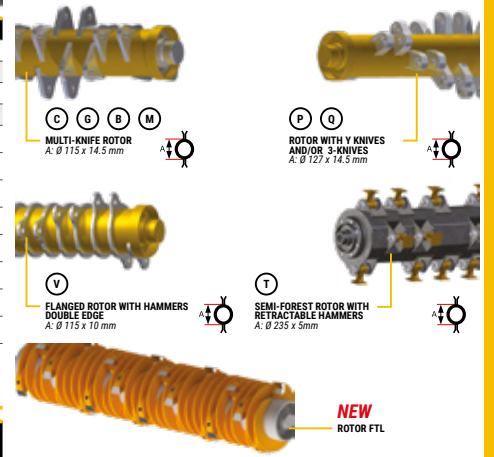



8 ÷ 14 ton.





max Ø 10/12 cm

FORREST PROF, a mulcher for excavators, also available with "Flanges Tool Limiter" technology, with special steel profiles that limit the tools' depth of action, reducing the power demand and ensuring working speed and exceptional performance. A machine designed for cleaning bushes, shrubs and wood up to 12 cm in size, with a wide range of tools.

Equipped with an axial piston motor, for high working performance.

Available with a 35 cc or 44 cc motor, ideal for excavators from 8 to 14 t.

	RPM		
PISTON			
35 c.c.	2.500 - 3.000	85-100 lt/min	350 max BAR
44 c.c.	2.500 - 3.000	110-120 lt/min	350 max BAR





FORREST PROF

FOREST HYDRAULIC CUTTING HEAD

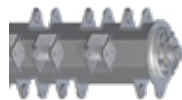

STRENGTH POINTS



FORREST PROF	125					NEW 125 FTL
						

TECHNICAL SPECIFICATIONS					
Working width	125 cm	125 cm	125 cm	125 cm	125 cm
Overall width total	145 cm	145 cm	145 cm	145 cm	145 cm
Machine weight*	515÷535 kg	515÷535 kg	515÷535 kg	545÷565 kg	550÷570 kg
Belts transmission	1 toothed belt	1 toothed belt	1 toothed belt	1 toothed belt	1 toothed belt
Tools	C max Ø 3 cm	N° 48	-	-	-
	G max Ø 4 cm	N° 24	-	-	-
	B max Ø 4 cm	N° 24	-	-	-
	M max Ø 6 cm	N° 24	-	-	-
	P max Ø 5 cm	-	N° 40	-	-
	Q max Ø 5 cm	-	N° 40+20	-	-
	V max Ø 8 cm	-	-	N° 24	-
T max Ø 10/12 cm	-	-	-	N° 20	-
 max Ø 10/12 cm	-	-	-	-	N° 26

FORREST PROF	125 / NEW 125 FTL
MACHINE	
Steel frame with internal Hardox frame (double frame)	✓
Static knife in Hardox and blade cutting system	✓
Replaceable skids with adjustable and replaceable pads	✓
Front and rear protection chains	✓
Mechanical rotation 180°	•
Hydraulic rotation 180° (n°2 hydraulic hoses)	•
Standard mounting brackets (no pins)	•
Adapters	•
TRANSMISSION	
Unidirectional engine at axial pistons with external drainage	✓
Semiforestral rotor with rotating hammers with tool "T"	✓
Double-row self-aligning ball bearings	✓
Unidirectional rotor rotation	✓
Transmission with toothed belt	✓
HYDRAULIC SYSTEM	
One way valve on return	✓
ORSI V3, 1-3/4 which includes valve of max. pressure + anticavitation valve + flow regulator. 3 connecting hoses to the machine. Max backpressure on oil drainage = 2 BAR	✓

FORREST PROF

PROFESSIONAL SERIES

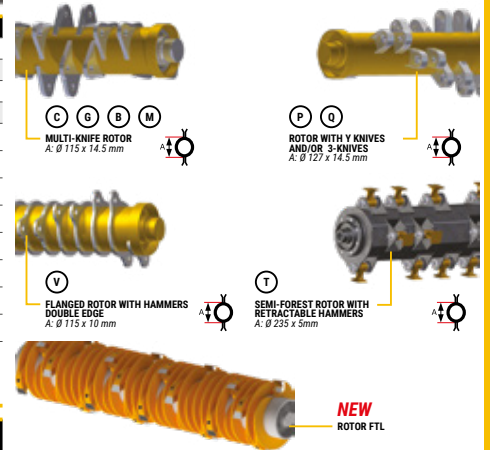



10 ÷ 18 ton.



max Ø 20 cm



EMR Piston, designed for excavators from 10 to 18 tons, able to shred logs up to 20 cm in diameter, available in two working widths: 110 and 140 cm. It mounts a rotor with retractable hammers, and an axial piston motor, making it a professional and high-performance machine.

HARDOX
IN MY BODY

EMR PISTON

FOREST HYDRAULIC CUTTING HEAD



	RPM		
PISTON CIL. FISSA			
45 c.c.	1.800 - 2.200	80=100 lt/min	350 max BAR
56 c.c.	1.800 - 2.200	100=125 lt/min	350 max BAR
63 c.c.	1.800 - 2.200	110=140 lt/min	350 max BAR
PISTON CIL. VARIABILE (optional)			
56/80 c.c.	1.800 - 2.200	110=130 lt/min	350 max BAR

STRENGTH POINTS



EMR PISTON

PROFESSIONAL SERIES

EMR PISTON	110	145
TECHNICAL SPECIFICATIONS		
Working width	110 cm	140 cm
Overall width total	136 cm	166 cm
Machine weight*	650-750 kg	730-830 kg
Belts transmission	5 belts	6 belts
tools 	N° 16	N° 24

EMR PISTON	110	145
MACHINE		
Frame in Hardox	✓	✓
Counter knife and blade cutting system	✓	✓
Replaceable skids with adjustable and replaceable pads	✓	✓
Protection chains	✓	✓
Standard mounting brackets (no pins)	•	•
Adapters	•	•
TRANSMISSION		
Fixed displacement piston engine REXROTH with external	✓	✓
Octagonal rotor Ø 450 mm with retractable rotating hammers	✓	✓
Double-row self-aligning roller bearings	✓	✓
Belts transmission	✓	✓
Unidirectional rotor rotation	✓	✓
Rexroth axial piston motor with variable displacement cc 56/80	•	•
HYDRAULIC SYSTEM		
One way valve on return	✓	✓
ORSI V3.1-3/4 (V3.1 - 1" with engine 80cc) which includes valve of max. pressure + anticavitation valve + flow regulator. 3 connecting hoses to the machine. Max backpressure on oil drainage = 2 BAR	✓	✓





10 ÷ 18 ton.



max Ø 25 cm



EMF Piston, designed for excavators from 10 to 18 tons, able to shred logs up to 25 cm in diameter, available in two working widths: 110 and 140 cm. It mounts a rotor with fixed hammers with tungsten inserts, and an axial piston motor, making it a professional and high-performance machine.

HARDOX
IN MY BODY

EMF PISTON

FOREST HYDRAULIC CUTTING HEAD



	RPM		
PISTON CIL. FISSA			
45 c.c.	1.800 - 2.200	80=100 lt/min	350 max BAR
56 c.c.	1.800 - 2.200	100=125 lt/min	350 max BAR
63 c.c.	1.800 - 2.200	110=140 lt/min	350 max BAR
PISTON CIL. VARIABILE (optional)			
56/80 c.c.	1.800 - 2.200	110=130 lt/min	350 max BAR

STRENGTH POINTS



EMF PISTON

PROFESSIONAL SERIES

EMF PISTON	110	145
TECHNICAL SPECIFICATIONS		
Working width	110 cm	140 cm
Overall width total	136 cm	166 cm
Machine weight*	650-750 kg	730-830 kg
Belts transmission	5 belts	6 belts
tools	N° 28	N° 32

EMF PISTON	110	145
MACHINE		
Frame in Hardox	✓	✓
Counter knife and blade cutting system	✓	✓
Replaceable skids with adjustable and replaceable pads	✓	✓
Protection chains	✓	✓
Standard mounting brackets (no pins)	•	•
Adapters	•	•
TRANSMISSION		
Fixed displacement piston engine REXROTH with external	✓	✓
Ø 450 mm helical rotor with fixed tungsten tools	✓	✓
Double-row self-aligning roller bearings	✓	✓
Belts transmission	✓	✓
Unidirectional rotor rotation	✓	✓
Rexroth axial piston motor with variable displacement cc 56/80	•	•
HYDRAULIC SYSTEM		
One way valve on return	✓	✓
ORSI V3.1-34 (V3.1 - 1" with engine 80cc) which includes valve of max. pressure + anticavitation valve + flow regulator. 3 connecting hoses to the machine. Max backpressure on oil drainage = 2 BAR	✓	✓





14 ÷ 30 ton.



max Ø 30 cm



TMF Piston, designed for large excavators from 14 to 30 tons, able to shred logs up to 30 cm in diameter, available in two working widths: 140 and 170 cm.

It mounts a rotor with retractable hammers, and an axial piston motor, making it a professional and high-performance machine.

TMF PISTON

FOREST HYDRAULIC CUTTING HEAD



	RPM		
PISTON CIL. FISSA			
56 c.c.	1.800 - 2.200	100-125 lt/min	350 max BAR
63 c.c.	1.800 - 2.200	110-140 lt/min	350 max BAR
80 c.c.	1.800 - 2.200	144-175 lt/min	350 max BAR
107 c.c.	1.800 - 2.200	190-235 lt/min	350 max BAR
PISTON CIL. VARIABLE (optional)			
56/80 c.c.	1.800 - 2.200	110-130 lt/min	350 max BAR

STRENGTH POINTS



TMF PISTON

PROFESSIONAL SERIES

TMF PISTON	140	170
TECHNICAL SPECIFICATIONS		
Working width	140 cm	170 cm
Overall width total	177 cm	207 cm
Machine weight*	1070-1270 kg	1150-1350 kg
Belts transmission	6 belts	6 belts
tools	N° 24	N° 28

TMF PISTON	140	170
MACHINE		
Weldox 700 frame and internal Hardox frame (double frame)	✓	✓
Double counter knife in Hardox	✓	✓
Replaceable skids with adjustable and replaceable pads	✓	✓
Protection chains	✓	✓
Standard mounting brackets (no pins)	•	•
Adapters	•	•
TRANSMISSION		
Fixed displacement piston engine REXROTH with external	✓	✓
Octagonal rotor Ø 450 mm with retractable rotating hammers	✓	✓
Double-row self-aligning roller bearings	✓	✓
Belts transmission	✓	✓
Unidirectional rotor rotation	✓	✓
Rexroth axial piston motor with variable displacement cc 56/80	•	•
HYDRAULIC SYSTEM		
One way valve on return	✓	✓
ORSI V3.1-3/4 (V3.1 - 1" with engine over 63 cc) which includes valve of max. pressure + anticavitation valve + flow regulator. 3 connecting hoses to the machine. Max backpressure on oil drainage = 2 BAR	✓	✓

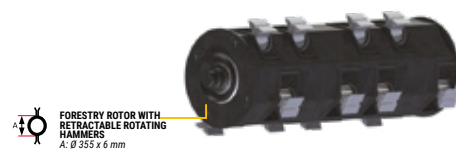
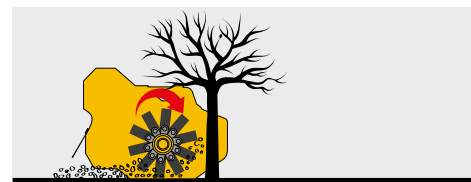



14 ÷ 30 ton.



max Ø 30 cm



TPF Piston designed for large excavators from 14 to 30 tons, able to shred logs up to 30 cm in diameter, available in two working widths: 140 and 170 cm.

It mounts a rotor with fixed hammers and tungsten inserts, and also an axial piston motor, making it a professional and high-performance machine.

TPF PISTON

FOREST HYDRAULIC CUTTING HEAD



	RPM		
PISTON CIL. FISSA			
56 c.c.	1.800 - 2.200	100-125 lt/min	350 max BAR
63 c.c.	1.800 - 2.200	110-140 lt/min	350 max BAR
80 c.c.	1.800 - 2.200	144-175 lt/min	350 max BAR
107 c.c.	1.800 - 2.200	190-235 lt/min	350 max BAR
PISTON CIL. VARIABLE (optional)			
56/80 c.c.	1.800 - 2.200	110-130 lt/min	350 max BAR

STRENGTH POINTS



TPF PISTON

PROFESSIONAL SERIES

TPF PISTON	140	170
TECHNICAL SPECIFICATIONS		
Working width	140 cm	170 cm
Overall width total	177 cm	207 cm
Machine weight*	1100-1300 kg	1210-1410 kg
Belts transmission	6 belts	6 belts
tools	N° 32	N° 36

TPF PISTON	140	170
MACHINE		
Weldox 700 frame and internal Hardox frame (double frame)	✓	✓
Double counter knife in Hardox	✓	✓
Replaceable skids with adjustable and replaceable pads	✓	✓
Protection chains	✓	✓
Standard mounting brackets (no pins)	•	•
Adapters	•	•
TRANSMISSION		
Fixed displacement piston engine REXROTH with external	✓	✓
Ø 450 mm helical rotor with fixed tungsten tools	✓	✓
Double-row self-aligning roller bearings	✓	✓
Belts transmission	✓	✓
Unidirectional rotor rotation	✓	✓
Rexroth axial piston motor with variable displacement cc 56/80	•	•
HYDRAULIC SYSTEM		
One way valve on return	✓	✓
ORSI V3.1-34 (V3.1 - 1" with engine over 63 cc) which includes valve of max. pressure + anticavitation valve + flow regulator. 3 connecting hoses to the machine. Max backpressure on oil drainage = 2 BAR	✓	✓





8 ÷ 15 ton.



max Ø 15 cm

PFC 1350 Professional Hardox mowing plate, ideal for excavators from 8 to 15 t, cutting width up to 15 cm, ideal for shrubs and woody material.

Available with blades or with chains, if you have to work in stony areas, motor with axial pistons for high working performance.



PFC 1350

MOWING PLATE WITH CHAINS - BLADES



STRENGTH POINTS



		
73c.c.	110 -120 lt/min	250 max BAR
PISTON		
63 c.c.	100-110 lt/min	350 max BAR

PFC 1350

PROFESSIONAL SERIES

PFC 1350	CHAINS	PISTON CHAINS	BLADES	PISTON BLADES
TECHNICAL SPECIFICATIONS				
Working width	135 cm	135 cm	135 cm	135 cm
Overall width total	150 cm	150 cm	150 cm	150 cm
Machine weight*	515-585 kg	525-595 kg	515-585 kg	525-595 kg
 Maximum cutting thickness	3 cm	5 cm	8 cm	15 cm
Rpm Pto	1500-1640	1575-1740	1500-1640	1575-1740

PFC	1350
MACHINE	
Frame in Hardox 500	✓
Adjustable support slides	✓
Bonnet adjustable in two positions	✓
Front and rear rubber and chain protections	✓
Chain cut tool (CT) or Hardox blades (LM)	✓
Standard mounting brackets (no pins)	•
Adapters	•
TRANSMISSION	
Vertical axis engine with gears or axial pistons	✓
HYDRAULIC SYSTEM	
Flow regulator and one way valve on return	✓
ORSI V3.1-3/4 which includes valve of max. pressure + anticavitation valve + flow regulator. 3 connecting hoses to the machine. Max backpressure on oil drainage = 2 BAR	✓



*machine weight based on the layout



1,5 ÷ 13 ton.



10 ton.

FC, a compact stump cutter, for the shredding of single stumps in woods, parks, on the sides of roads or rivers. Its small size makes it particularly handy and suitable for excavators from 1.5 to 13 t. The piston motor makes it a very professional machine with high performance. Available with different sizes of the cutting disc, from 400 to 540 cm.



FC - GRIND STUMPS

PROFESSIONAL SERIES

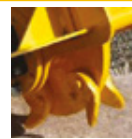

STRENGTH POINTS



		RPM		
FC 20	12 c.c	1.700 - 2.900	20÷35 lt/min	350 max BAR
FC 40	18 c.c.	1.700 - 2.800	30÷50 lt/min	350 max BAR
FC 90	32 c.c.	1.600 - 2.200	50÷70 lt/min	350 max BAR
FC 130	41 c.c.	1.600 - 2.200	65÷90 lt/min	350 max BAR

FC - GRIND STUMPS

PROFESSIONAL SERIES

FC - GRIND STUMPS	20	40	90	130
TECHNICAL SPECIFICATIONS				
Machine weight*	80=120 kg	80=130 kg	210=300 kg	210=350 kg
 Diameter of the cutting disc Ø mm	400 cm	400 cm	540 cm	540 cm
N° tools	12	12	16	16

FC - GRIND STUMPS	20	40	90	130
MACHINE				
Steel frame, compact but strong	✓	✓	✓	✓
Front and side chain protection	✓	✓	✓	✓
Cutting disc with interchangeable teeth with tungsten insert	✓	✓	✓	✓
Side bearings	✓	✓	✓	✓
Upper plate for mounting brackets	✓	✓	✓	✓
Standard mounting brackets (no pins)	•	•	•	•
Adapters	•	•	•	•
Connection for hydraulic rotation for skid "universal type" (A.)	•	•	•	•
Connection for hydraulic rotation for blades (not universal) (B.)	•	•	•	•
TRANSMISSION				
Hydraulic piston motor for high performance	✓	✓	✓	✓
HYDRAULIC SYSTEM				
By-pass valve on hydraulic motor	✓	✓	✓	✓
3 connection hoses (delivery, return and drainage) MAX back pressure on oil drainage = 2 BAR	✓	✓	✓	✓

GRIND STUMPS





DISC HEDGE CUTTER

PROFESSIONAL SERIES



STRENGTH POINTS



Discs bar with unidirectional gear engine with external drainage (3 hoses: ingoing, outgoing and drainage with max backpressure 5 bar)

35 lt/min	150 max BAR
40 lt/min	150 max BAR

DISC HEDGE CUTTER	165
TECHNICAL SPECIFICATIONS	A
Thickness of cutting knives	2 cm
N° knives	8
Disc cutting thickness	4 cm
N° disc for wood Ø 500 cm	4 optional (B.)
Min power request	kW 14,5 - 20 HP
Working temperature	-15° C + +80° C
Advised working speed	1000 m/h
Width	165 cm
OPTIONAL	165
Standard mounting brackets (no pins)	•
Adapters	•
ORSI V3.1 - 1/2	•
Toothed discs for wood "B" (n.4 pieces)	•



DISC HEDGE CUTTER *PROF*

PROFESSIONAL SERIES



STRENGTH POINTS



	
80 lt/min	150 max BAR

DISC HEDGE CUTTER <i>PROF</i>	200
TECHNICAL SPECIFICATIONS	
Cutting thickness dimensions	15 cm
N° disc for wood Ø 650 mm	4
Min power request	kW 14,5 - 20 HP
Working temperature	-15° C ÷ +80° C
Advised working speed	1000 m/h
OPTIONAL	165
Standard mounting brackets (no pins)	•
Adapters	•

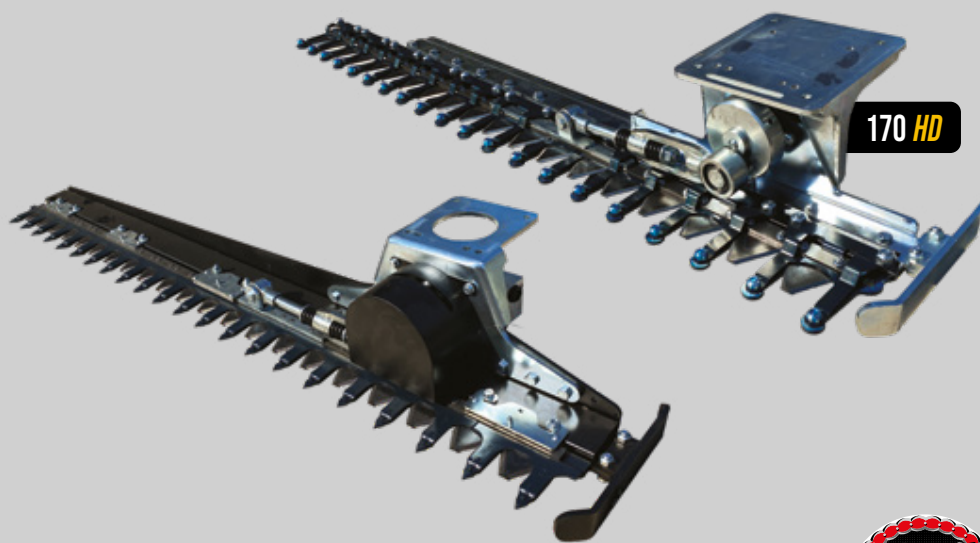

HEDGE BAR



PROFESSIONAL SERIES



STRENGTH POINTS



Cutter bar designed for profiling of hedges. Ideal to be installed on the arms of the mini excavators, presents a huge versatility of work. Maximum cut, branches of 3 cm.

	
35-55 lt/min	120 max BAR

HEDGE BAR	125	166	200	170 HD
TECHNICAL SPECIFICATIONS				
Min power request	kw 14,5 20 HP	kw 14,5 20 HP	kw 14,5 20 HP	kw 14,5 20 HP
Working temperature	-15° C ÷ +80° C	-15° C ÷ +80° C	-15° C ÷ +80° C	-15° C ÷ +80° C
Advised working speed	2000 m/h	2000 m/h	2000 m/h	2000 m/h
Min. - Max. Frequency	200 - 300 cycles/min	200 - 300 cycles/min	200 - 300 cycles/min	200 - 300 cycles/min
Width	125 cm	166 cm	200 cm	170 cm
Weight	46 kg	58 kg	68 kg	68 kg
 Maximum cutting thickness	3 cm	3 cm	3 cm	5 cm
	125	166	200	170 HD
Unidirectional orbital engine with internal drainage (2 hoses)	✓	✓	✓	✓
Supporto per fissaggio sella di attacco	✓	✓	✓	✓
ORSI V3.1 - integrated	✓	✓	✓	✓
Standard mounting brackets (no pins)	•	•	•	•
Adattatore	•	•	•	•





BRANCH CUTTER

PROFESSIONAL SERIES



Branches bar with inverter and automatic pressure relief valve, for branches up to 12 cm in diameter.

	
35±55 lt/min	120 max BAR

BRANCH CUTTER	155 HARDOX	225 HARDOX
TECHNICAL SPECIFICATIONS	A	
Min power request	kW 19 - 25 HP	kW 19 - 25 HP
Working temperature	-5° C ÷ +70° C	-5° C ÷ +70° C
Advised working speed	0 - 800 m/h	0 - 800 m/h
Min. - Max. Frequency	50 - 65 cycles/min	50 - 65 cycles/min
Width	155 cm	225 cm
Weight	200 kg	230 kg
 Maximum cutting thickness	10 cm	10 cm
Automatic anti-jam inverter	✓	✓
Maximum pressure valve and flow divider	✓	✓
Standard mounting brackets (no pins)	•	•
Accessories	•	•



DITCH CLEANER

PROFESSIONAL SERIES



For ditches cleaning with unidirectional orbital engine with external drainage (3 hoses: ingoing - outgoing and drainage with back pressure max 5 bar)



	
90-120 lt/min	250 max BAR

DITCH CLEANER	Ø 50	Ø 65	Ø 80	Ø 100
TECHNICAL SPECIFICATIONS				
Weight	130 kg	190 kg	230 kg	270 kg
Ø cm	50 cm	65 cm	80 cm	100 cm
	Ø 50	Ø 65	Ø 80	Ø 100
Unidirectional orbital engine with external drainage (3 hoses: ingoing-outgoing and drainage with back pressure max 5 BAR)	✓	✓	✓	✓
Standard mounting brackets (no pins)	•	•	•	•
Adapters	•	•	•	•
 Flux regulator 150 ÷ 90 lt/min	•	•	•	•

FIXING PLATE

SELLA DI ATTACCO STANDARD
STANDARD HITCH SADDLE

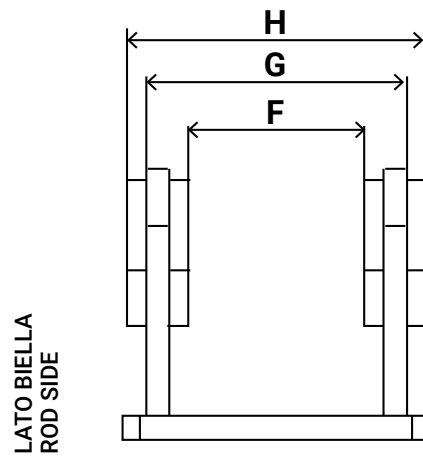
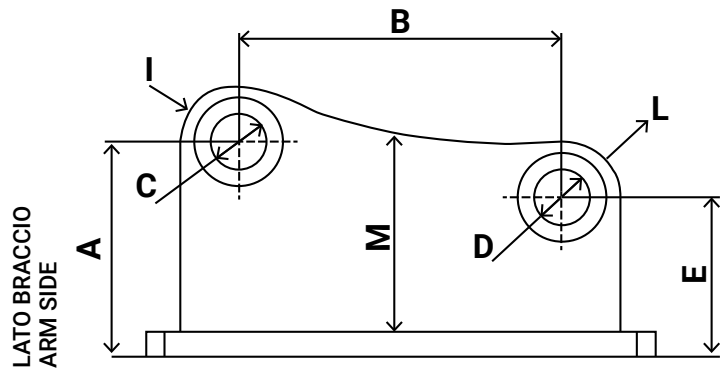





1,2 ÷ 15 ton.



max Ø 5 cm

Hydraulic shredder for miniskids, loaders and telescopic booms up to 15 tons. Designed for machines to cut grass, brambles, bushes and reeds.

	RPM		
27 c.c.	2.300 - 2.500	38-46 lt/min	250 max BAR
38 c.c.	2.300 - 2.500	55-65 lt/min	250 max BAR
51 c.c.	2.300 - 2.500	75-87 lt/min	250 max BAR
61 c.c.	2.200 - 2.400	90-100 lt/min	250 max BAR

TECNIK *HYDRO*

HYDRAULIC SHREDDER



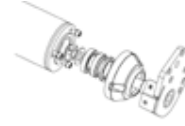
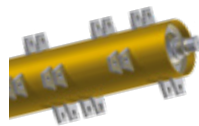

STRENGTH POINTS



TECNIK *HYDRO*

PROFESSIONAL SERIES

TECNIK <i>HYDRO</i>		135	165	180	200	220	255
TECHNICAL SPECIFICATIONS							
Working width		135 cm	162 cm	181 cm	201 cm	221 cm	253 cm
Overall width		155 cm	180 cm	200 cm	220 cm	240 cm	275 cm
Machine weight*		610 kg	650 kg	690 kg	730 kg	800 kg	910 kg
Belts transmission		4 belts quad power	4 belts quad power	4 belts quad power	4 belts quad power	4 belts quad power	4 belts quad power
Tools	 Knives A max Ø 3 cm	N° 36	N° 36	N° 48	N° 48	N° 60	N° 60
	 Hammers B max Ø 5 cm	N° 12	N° 12	N° 16	N° 16	N° 20	N° 20

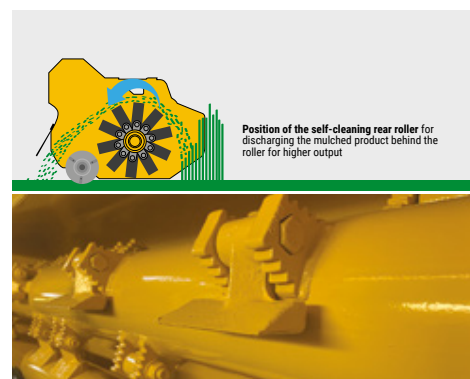

TECNIK <i>HYDRO</i>	135	165	180	200	220	255	
MACHINE							
Steel frame with internal Hardox frame (double frame)	✓	✓	✓	✓	✓	✓	
Static knife in Hardox and blade cutting system	✓	✓	✓	✓	✓	✓	
Rear roller Ø 140 mm with 4 tapered roller bearings and interchangeable central body thickness 6 mm, adjustable in height	✓	✓	✓	✓	✓	✓	
Front protection flaps	✓	✓	✓	✓	✓	✓	
Automatic belt tensioner	✓	✓	✓	✓	✓	✓	
Swinging coupler for skid steer loader universal type	✓	✓	✓	✓	✓	✓	
Protection chains	•	•	•	•	•	•	
Hydraulic side shift with machine already set up	•	•	•	•	•	•	
Hydraulic side shift with 6 - way solenoid valve 12 Volt	•	•	•	•	•	•	
Replaceable skids	•	•	•	•	•	•	
Extra cost for non-universal blade attachment	•	•	•	•	•	•	
TRANSMISSION							
VARISEAL engine with external drainage	✓	✓	✓	✓	✓	✓	
Belt transmission	✓	✓	✓	✓	✓	✓	
Ventilator rotor	✓	✓	✓	✓	✓	✓	
Double-row self-aligning roller bearings	✓	✓	✓	✓	✓	✓	
Unidirectional rotor rotation	✓	✓	✓	✓	✓	✓	
HYDRAULIC SYSTEM							
One way valve on return	✓	✓	✓	✓	✓	✓	
ORSI V3.1-3/4 (V3.1 - 1" with engine 61cc 150=170l/min) which includes valve of max. pressure + anticavitation valve + flow regulator. 3 connecting hoses to the machine. Max backpressure on oil drainage = 2 BAR	✓	✓	✓	✓	✓	✓	







1,2 ÷ 15 ton.



max Ø 5 cm

Hydraulic shredder for miniskids, loaders and telescopic up to 15 ton.
Designed for machines to cut grass, brambles, bushes and reeds.

	RPM		
35 c.c.	2.300 - 2.500	50-60 lt/min	350 max BAR
44 c.c.	2.300 - 2.500	65-75 lt/min	350 max BAR

TECNIK PISTON

HYDRAULIC SHREDDER



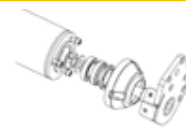
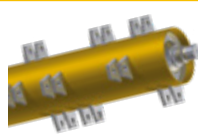

PUNTI DI FORZA



TECNIK PISTON

PROFESSIONAL SERIES

TECNIK PISTON		135	165	180	200	220	255
TECHNICAL SPECIFICATIONS							
Working width		135 cm	162 cm	181 cm	201 cm	221 cm	253 cm
Overall width		155 cm	180 cm	200 cm	220 cm	240 cm	275 cm
Machine weight*		610 kg	650 kg	690 kg	730 kg	800 kg	910 kg
Belts transmission		4 correas quad power	4 correas quad power	4 correas quad power	4 correas quad power	4 correas quad power	4 correas quad power
tools	 Knives A max Ø 3 cm	N° 36	N° 36	N° 48	N° 48	N° 60	N° 60
	 Hammers B max Ø 5 cm	N° 12	N° 12	N° 16	N° 16	N° 20	N° 20

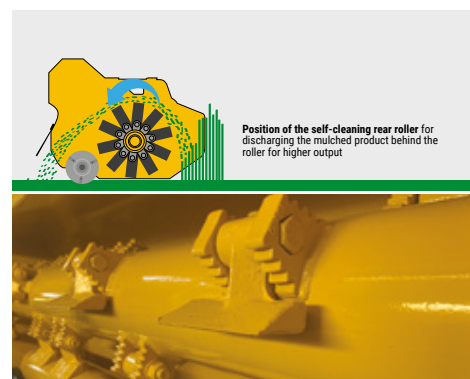

TECNIK PISTON	135	165	180	200	220	255	
MACHINE							
Steel frame with internal Hardox frame (double frame)	✓	✓	✓	✓	✓	✓	
Static knife in Hardox and blade cutting system	✓	✓	✓	✓	✓	✓	
Rear roller Ø 140 mm with 4 tapered roller bearings and interchangeable central body thickness 6 mm, adjustable in height	✓	✓	✓	✓	✓	✓	
Front protection flaps	✓	✓	✓	✓	✓	✓	
Automatic belt tensioner	✓	✓	✓	✓	✓	✓	
Swinging coupler for skid steer loader universal type	✓	✓	✓	✓	✓	✓	
Protection chains	•	•	•	•	•	•	
Hydraulic side shift with machine already set up	•	•	•	•	•	•	
Hydraulic side shift with 6 - way solenoid valve 12 Volt	•	•	•	•	•	•	
Replaceable skids	•	•	•	•	•	•	
Extra cost for non-universal blade attachment	•	•	•	•	•	•	
TRANSMISSIONE							
VARISEAL engine with external drainage	✓	✓	✓	✓	✓	✓	
Toothed belt transmission	✓	✓	✓	✓	✓	✓	
Ventilator rotor	✓	✓	✓	✓	✓	✓	
Double-row self-aligning roller bearings	✓	✓	✓	✓	✓	✓	
Unidirectional rotor rotation	✓	✓	✓	✓	✓	✓	
HYDRAULIC SYSTEM							
One way valve on return	✓	✓	✓	✓	✓	✓	
ORSI V3.1-3/4 which includes valve of max. pressure + anticavitation valve + flow regulator. 3 connecting hoses to the machine. Max backpressure on oil drainage = 2 BAR	✓	✓	✓	✓	✓	✓	





BEARS FORREST *PISTON*

FORESTRY SERIES

HARDOX
IN MY BODY



SUPER COMPACT SKID

Mulcher designed for Skid-Steer loaders, with specially reinforced frame to withstand the axial loads caused by the specific movement styles of this group of vehicles hard conditions. Mulchers designed for all shredding operations of bushes, branches, and trees up to a maximum diameter of 18/20 cm depending on the condition of the product to be shredded. Octagonal forest type rotor with retractable forged hammers. A machine equipped with screw adjustable and interchangeable side skirts, with two rows of counter-knives that guarantee a fine and homogeneous shredding. The hood is hydraulic adjustable by a protected and integrated cylinder within the double HARDOX® frame, completely closed / dustproof.

Double row of front protection chains, with screwed plates that limit the escape of shredded material, protecting the operator and the tractor/cabin at the same time. Mechanical arch for pushing down branches whilst protecting the tractor, helping convey the material to the rotor for better shredding. Double-edged tools allow them to be reversed when worn and therefore take advantage of the other side extending their life. Very sturdy and compact, BEARS FORREST PISTON stands out for its ergonomic design that guarantees excellent visibility for the operator during the various operations.

It can be used with any brand of Skid Steer Loader on the market thanks to our "SMARTFIT" Universal hitch. Fitted with a REXROTH® AXIAL PISTON hydraulic motor or optionally available with a VARIABLE DISPLACEMENT PISTON HYDRAULIC MOTOR (REXROTH® a Bosch Company®) with automatic variable flow rate, which allows increased productivity and at the same time reduced consumption. Dustproof chassis with reinforced side to withstand the axial load of skid steers, with hydraulic opening and closing of the hood.

Standard with the ORSI developed '3 in 1' hydraulic circuit valve giving this machine the advantage that it can be easily used on all models of different Skid Steer Loader brands.

BEARS FORREST *PISTON* FORESTRY SERIES



25 ton.



max Ø 18/20 cm

**OVERGROWN VEGETATION,
BRANCHES, SHRUBS**

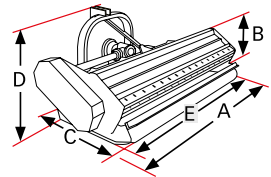

	RPM		
PISTON CIL. FISSA			
45 c.c.	1.800 - 2.200	65=80 lt/min	350 max BAR
56 c.c.	1.800 - 2.200	80=100 lt/min	350 max BAR
63 c.c.	1.800 - 2.200	90=100 lt/min	350 max BAR
80 c.c.	1.800 - 2.200	110=140 lt/min	350 max BAR
PISTON CIL. VARIABILE (optional)			
56/80 c.c.	1.800 - 2.200	85=110 lt/min	350 max BAR

BEARS FORREST <i>PISTON</i>	A cm	B cm	C cm	D cm	E cm
170	202	53	118	113	170
210	224	53	118	113	192
255	252	53	118	113	223

STRENGTH POINTS

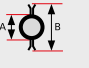

BEARS FORREST <i>PISTON</i>		170	210	250
TECHNICAL SPECIFICATIONS				
Working width		170 mm 66,9"	192 mm 75,6"	223 mm 87,8"
Machine weight*		1180 kg 2607 lbs	1370 kg 3020 lbs	1550 kg 3417 lbs
DOIS  hammers Kg 1,75		N° 28	N° 32	N° 40
	A	350x8 mm 13,8"x0,32"	350x8 mm 13,8"x0,32"	350x8 mm 13,8"x0,32"
	B	450 mm 17,7"	450 mm 17,7"	450 mm 17,7"
N° belts		6	6	6

BEARS FORREST *PISTON*

PROFESSIONAL SERIES

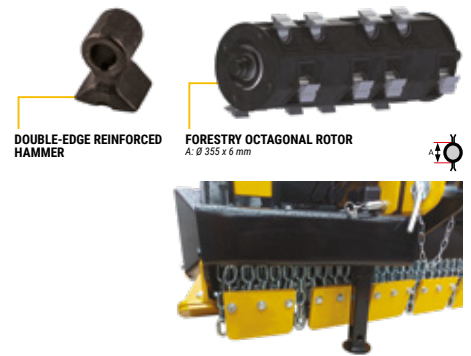

BEARS FORREST <i>PISTON</i>	170	210	250
MACHINE			
Double frame in Hardox	✓	✓	✓
Hardox counter-knives	✓	✓	✓
Hydraulic rear tailgate	✓	✓	✓
Bonnet with a double row of protective chains	✓	✓	✓
Adjustable height skids in Hardox steel	✓	✓	✓
Completely closed and dustproof frame	✓	✓	✓
Double row of protective chains with screwed flaps	✓	✓	✓
Reflectors	✓	✓	✓
Swinging coupler for skid steer loader universal type	✓	✓	✓
Mechanically adjustable arch for pushing down branches	✓	✓	✓
Hydraulically adjustable arch for pushing down branches	-	-	-
A. 6 way solenoid valve 12 Volt for machine not set up for command bonnet opening	-	-	-
B. Extra cost for non-universal blade attachment	-	-	-
TRANSMISSION			
Unidirectional motor with external axial piston drainage	✓	✓	✓
Lateral transmission with 6 belts	✓	✓	✓
Octagonal rotor Ø 450 mm with retractable forged hammers	✓	✓	✓
Double-row self-aligning roller bearings	✓	✓	✓
Automatic belt tensioner	✓	✓	✓
Rexroth axial piston motor with variable displacement cc 56/80	-	-	-
HYDRAULIC SYSTEM			
One way valve on return	✓	✓	✓
ORSI V3.1-1 which includes valve of max. pressure + anticavitation valve + flow regulator MAX back pressure on oil drainage = 2 BAR	✓	✓	✓

*variable weight based on the layout





HULK FORREST *PISTON*

FORESTRY SERIES



HULK FORREST *PISTON*

PROFESSIONAL SERIES



25 ton.



max Ø 25 cm

OVERGROWN VEGETATION,
BRANCHES, SHRUBS

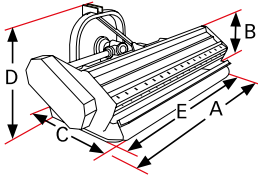

NEW UNIVERSE SKID

Mulcher designed for Skid-Steer loaders, for all shredding operations of bushes, branches and trees up to a maximum diameter of 25 cm, equipped with helical forestry rotor Ø 450 mm with fixed tools. The specially reinforced frame to withstand the axial loads caused by the movement of the skid steers in demanding conditions is equipped with screw adjustable interchangeable support skids and with two rows of HARDOX® counter-knives that guarantee a fine and homogeneous shredding. The hood is hydraulically adjustable with cylinder integrated and protected in the Hardox double frame. Double row of front protection chains, with screwed plates that limit the escape of shredded material whilst protecting the operator and the tractor / cab at the same time.

Mechanical arch for pushing down branches whilst protecting the tractor, helping convey the material to the rotor for better shredding. On request, this can be hydraulically operated for greater ease of use and comfort. Fixed tools in wear resistant tungsten carbide for highly professional and difficult jobs. Double-edged tools allow them to be reversed when worn and therefore take advantage of the other side for longer life. With a sturdy and professional rotor, the HULK FORREST PISTON stands out for its ergonomic design that guarantees excellent visibility for the operator during the various operations. It can be used with any brand of Skid Steer Loader on the market thanks to our "SMARTFIT" Universal hitch. Supplied with a REXROTH® AXIAL PISTON hydraulic motor or optionally available with the VARIABLE DISPLACEMENT PISTON HYDRAULIC MOTOR (REXROTH® a Bosch Company®) with automatic variable flow rate, which allows increased productivity and reduced consumption at the same time. Dustproof chassis and reinforced side to withstand the axial load of the crawlers, hydraulic opening and closing of the hood.

Standard with valve developed by ORSI 3 in 1 which allows to have advantages in the hydraulic circuit to be easily used on all models of different Skid Steer Loader brands.

Icon	RPM	Water Drop	Pressure Gauge
PISTON CIL. FISSA			
45 c.c.	1.800 - 2.200	65=80 lt/min	350 max BAR
56 c.c.	1.800 - 2.200	80=100 lt/min	350 max BAR
63 c.c.	1.800 - 2.200	90=100 lt/min	350 max BAR
80 c.c.	1.800 - 2.200	110=140 lt/min	350 max BAR
PISTON CIL. VARIABILE (optional)			
56/80 c.c.	1.800 - 2.200	85=110 lt/min	350 max BAR

HULK FORREST PISTON	A cm	B cm	C cm	D cm	E cm
170	202	53	118	113	170
210	224	53	118	113	192
250	252	53	118	113	223



STRENGTH POINTS

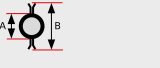

HULK FORREST PISTON		170	210	250
TECHNICAL SPECIFICATIONS				
Working width		170 mm 66,9"	192 mm 75,6"	220 mm 86,6"
Machine weight*		1480 kg 3263 lbs	1590 kg 3505 lbs	1680 kg 3703 lbs
Tools  hammers Kg 1,6		N° 36	N° 40	N° 48
	A	219x20 mm 8,6"x0,8"	219x20 mm 8,6"x0,8"	219x25 mm 8,6"x1"
	B	455 mm 17,9"	455 mm 17,9"	455 mm 17,9"
N° belts Powerband Triplex		2	2	2

HULK FORREST PISTON

PROFESSIONAL SERIES



HULK FORREST PISTON		170	210	250
MACHINE				
Double frame in Hardox		✓	✓	✓
Hardox counter-knives		✓	✓	✓
Hydraulic rear tailgate		✓	✓	✓
Bonnet with a double row of protective chains		✓	✓	✓
Adjustable height skids in Hardox steel		✓	✓	✓
Completely closed and dustproof frame		✓	✓	✓
Double row of protective chains with screwed flaps		✓	✓	✓
Reflectors		✓	✓	✓
Swinging coupler for skid steer loader universal type		✓	✓	✓
Mechanically adjustable arch for pushing down branches		✓	✓	✓
Hydraulically adjustable arch for pushing down branches		-	-	-
A. 6 way solenoid valve 12 Volt for machine not set up for command bonnet opening		-	-	-
B. Extra cost for non-universal blade attachment		-	-	-
TRANSMISSION				
Unidirectional motor with external axial piston drainage		✓	✓	✓
Lateral transmission with 6 belts		✓	✓	✓
Helical forest rotor Ø 450mm with fix tools in tungsten		✓	✓	✓
Double-row self-aligning roller bearings		✓	✓	✓
Double rotor support		✓	✓	✓
Automatic belt tensioner		✓	✓	✓
Rexroth axial piston motor with variable displacement cc 56/80		-	-	-
HYDRAULIC SYSTEM				
One way valve on return		✓	✓	✓
ORSI V3.1-1 which includes valve of max. pressure + anticavitation valve + flow regulator MAX back pressure on oil drainage = 2 BAR		✓	✓	✓





**WILD TO
SURVIVE**





По вопросам продаж и поддержки обращайтесь:

Алматы (7273)495-231
Ангарск (3955)60-70-56
Архангельск (8182)63-90-72
Астрахань (8512)99-46-04
Барнаул (3852)73-04-60
Белгород (4722)40-23-64
Благовещенск (4162)22-76-07
Брянск (4832)59-03-52
Владивосток (423)249-28-31
Владикавказ (8672)28-90-48
Владимир (4922)49-43-18
Волгоград (844)278-03-48
Вологда (8172)26-4159
Воронеж (473)204-51-73
Екатеринбург (343)384-55-89
Иваново (4932)77-34-06
Ижевск (3412)26-03-58
Иркутск (395)279-98-46
Казань (843)206-01-48

Калининград (4012)72-03-81
Калуга (4842)92-23-67
Кемерово (3842)65-04-62
Киров (8332)68-02-04
Коломна (4966)23-41-49
Кострома (4942)77-07-48
Краснодар (861)203-40-90
Красноярск (391)204-63-61
Курск (4712)77-13-04
Курган (3522)50-90-47
Липецк (4742)52-20-81
Магнитогорск (3519)55-03-13
Москва (495)268-04-70
Мурманск (8152)59-64-93
Набережные Челны (8552)20-53-41
Нижний Новгород (831)429-08-12
Новокузнецк (3843)20-46-81
Ноябрьск (3496)41-32-12
Новосибирск (383)227-86-73

Омск (3812)21-46-40
Орел (4862)44-53-42
Оренбург (3532)37-68-04
Пенза (8412)22-31-16
Петрозаводск (8142)55-98-37
Псков (8112)59-10-37
Пермь (342)205-81-47
Ростов-на-Дону (863)308-18-15
Рязань (4912)46-61-64
Самара (846)206-03-16
Саранск (8342)22-96-24
Санкт-Петербург (812)309-46-40
Саратов (845)249-38-78
Севастополь (8692)22-31-93
Симферополь (3652)67-13-56
Смоленск (4812)29-41-54
Сочи (862)225-72-31
Ставрополь (8652)20-65-13
Сургут (3462)77-98-35

Сыктывкар (8212)25-95-17
Тамбов (4752)50-40-97
Тверь (4822)63-31-35
Тольятти (8482)63-91-07
Томск (3822)98-41-53
Тула (4872)33-79-87
Тюмень (3452)66-21-18
Ульяновск (8422)24-23-59
Улан-Удэ (3012)59-97-51
Уфа (347)229-48-12
Хабаровск (4212)92-98-04
Чебоксары (8352)28-53-07
Челябинск (351)202-03-61
Череповец (8202)49-02-64
Чита (3022)38-34-83
Якутск (4112)23-90-97
Ярославль (4852)69-52-93

Россия +7(495)268-04-70

Казахстан +7(7172)727-132

Киргизия +996(312)96-26-47

Адрес: <https://orsi.nt-rt.ru> || эл.почта: ois@nt-rt.ru